

Smart Switch (WiFi + 2.4G)

Model: WL-SW1

Contents

<u>Feature</u>	2
<u>Parameters</u>	3
<u>Connection Diagram</u>	4
<u>Installation Diagram</u>	5
<u>Remote control instruction</u>	6-8
<u>App control instruction</u>	9-14
<u>Download "Tuya Smart" App</u>	9
<u>Pairing Network</u>	10
<u>Power On status</u>	11
<u>Switch Type</u>	12
<u>Timer Function</u>	13
<u>Multi Control Relation</u>	14
<u>Alexa voice control instruction</u>	15
<u>Google Home voice control instruction</u>	16
<u>Attention</u>	17

1. Feature

This product is made by WIFI+BLE+2.4G wireless technology with low consumption and strong ability for anti-interference. It works with WIFI+BLE+2.4G remote control, user can control devices in short distance even router is offline. Mini appearance can be inserted into EU and USA standard junction box, it's easy for wiring and installation. Controlled by Tuya Smart APP, support voice control, wide applied in lighting, socket, fans, humidifier, fireplace ON/OFF control



WiFi wireless control
support long-range control



Group Control



Smartphone
app control



Timing setting / countdown
turn on / off LED light



2.4G remote control
Control Distance 30m



Do not disturb
mode



2.4G RF wireless
transmission technology



Child Lock



Support third
party voice control



Device sharing



Auto transmitting
(only for remote)



Tap-to-Run &
automation

2. Parameter

Model No.: WL-SW1

Input Voltage: 100-240V~ 50/60Hz

Output Voltage: 100-240V~ 50/60Hz

Output Current: Max 10A

Switch Method: WiFi + 2.4G + (Push / Rocker switch)

Wireless Technology: Wi-Fi IEEE 802.11b/g/n 2.4GHz

RF: 2.4GHz

Working Temperature: -10~40°C

2.4G RF Control Distance: 30m

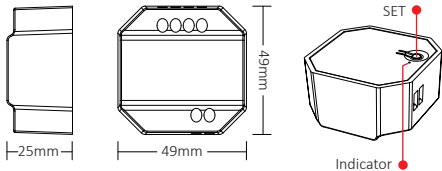

3. Connection Diagram

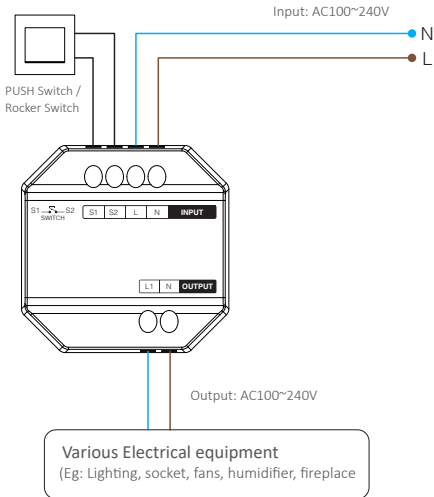

Warning

Ensure correct wiring for all cables before power on, otherwise it will damage devices.

4. Installation Diagram

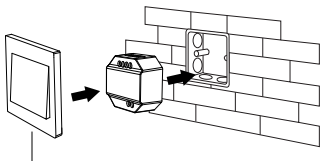

PUSH switch / Rocker switch

Support following standing junction box, The depth of junction box is over 50mm

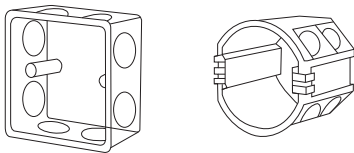

5. Remote Control Instruction

5.1. Linking

1). Activating unlinking mode

1: short press "SET" 1 time, indicator breathing.

2: power off dimmer 10 seconds, power on again.

3: (PUSH switch / Rocker switch) change "OFF" into "ON".

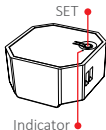

- 2). Press ON in any group zones 3 times within 3 seconds (Eg: "I" or "ON"), linking is done.

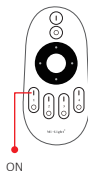

5.2. Unlinking

1). Activating unlinking mode

1: short press "SET" 1 time, indicator breathing.

2: power off dimmer 10 seconds, power on again.

3: (PUSH switch/ Rocker switch) change "OFF" into "ON".

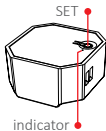

2). Press ON in any group zones 5 times within 3 seconds (Eg: "I" or "ON"), unlinking is done.

Attention: Linking or Unlinking must be in same group.

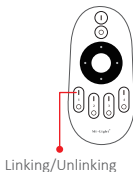

5.3. Compatible with remote controls (Purchased separately)



FUT006



FUT007



B1 / B1-B / T1



B2 / T2



K1 / K1-B



FUT087 / FUT087-B



S1-B / S1-W /
S1-G

5.3. Transmitting function instruction

Devices can transmit signal to another one if there is new device within 30m, countless control distance by auto transmitting.

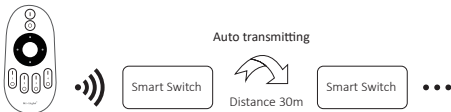

Attention: All "Smart Switch" must be linked with one remote.

6. Smartphone APP control instruction

6.1. Download and install [Tuya Smart] app

Search for **[Tuya Smart]** in application store or scan following QR code to download and install the app.

Please open the app click " Register " button to create account while using it in the first time, Log in directly if you already had account.



6.2. Pairing Network (5G router is useless)

- 1). Connect with power source.
- 2). Indicator flashes quickly (2 times per seconds)

Please review following steps if indicator not flashes quickly:

- Long press “SET”.
- Power on and power off device three times.
- (PUSH switch / rocker switch) connect with switch 5 times.

- 3). Link phone with 2.4G wifi network.
- 4). Enter APP, Click “+”.
- 5). Click “**Electrical**”, find “**Breaker (BLE+Wi-Fi)**”.
- 6). Finish pairing.

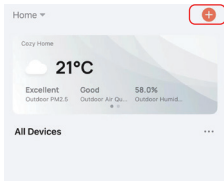

6.3. Power On Status

Click single device or group—Click “setting”—Click “Relay Status”—select status.

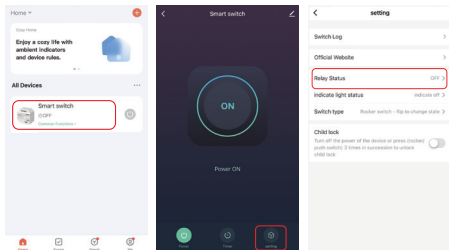

OFF: Device shutdown in any status if power source is off.

On: Device turn on in any status if power source is on.

Remember last status: Memorize the status before power off.

Eg: Device is working and power failure happened, device is on while power source recovered.

6.4. Switch Type Setting

Click single device or group—Click “configuration”—click “switch type”—select type (switch connection diagram in page 3).

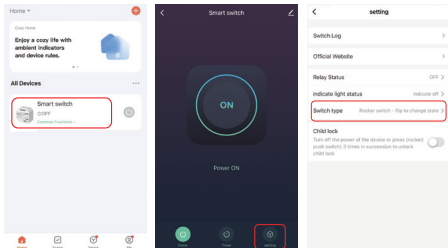

Rocker switch - flip to change state:

Eg: Device (use App or remote control) is on, push one time “Rocker switch (in any status)”, device is off.

Rocker switch - state synchronous:

Eg: Device (use App or remote control) is on, “Rocker switch” must be off, device is off.

Button switch: connect with PUSH switch (self reset switch/button switch), select this types.

6.5. Timer Setting

Click single device or group—Click “Timer”—select timer types.

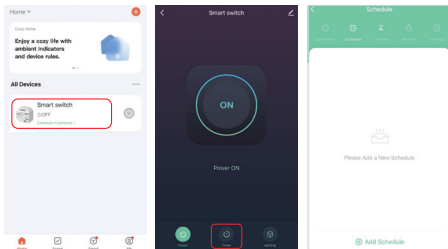

Attention:

1. The timer add max quantities is 30 pcs.
2. “Countdown” “Circulate” “Random” will be stopped if there is power failure (use APP or remote or rocker switch to turn on or off) in current period, timer function recovered in next period.

6.6. Multi Control Relation

1. Set up devices, turn on or off at the same time.
2. Click device—click “”—click “multi-control”—click “related on/off”—choose related device, relation is done.

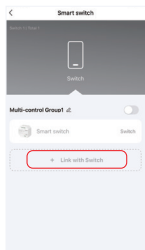
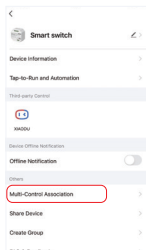
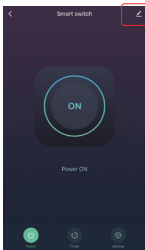
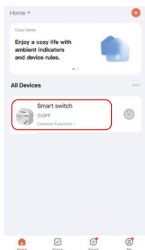

7. Alexa voice control instruction

Please add device into “Tuya Smart” app ([check details in page 10](#)) and start following steps:

- 1). Open Alexa App
- 2). Click “More” on the bottom of right corner
- 3). Click “Skills & Games”

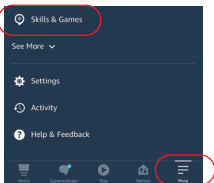

- 4). Click “Q” on the top of right corner
- 5). Type into “Smart life” and search



- 6). Click “Smart life” skill, follow instruction to finish configuration and start voice control

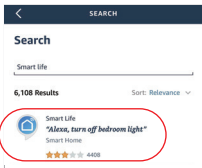

8. Google Home voice control instruction

Please add device into “Tuya Smart” app (check details in page 10) and start following steps:

- 1). Open Google Home App
- 2). Click “+” on the top of left corner

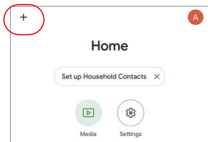

- 3). Click “Set up device”



- 4). Click “Works with Google”

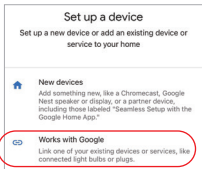

- 5). Click “Q” on the top of right corner
- 6). Type into “Smart life” and search
- 7). Click “Smart life” skill, follow instruction to finish configuration and start voice control



9. Attention

1. Please turn off power supply before installation.
2. Please ensure input voltage to be same as requirements from device.
3. Don't disassemble device if you are not expert, otherwise it will damage it.
4. Please do not use the light in the place with widely range metal area or strong electromagnetic wave nearby, otherwise, the remote distance will be seriously affected.

Made in China



Dimmer can not use in humid area