

LTECH

Super Smart Switch (4-Gang)



Manual
www.ltech-led.com

Application Diagram

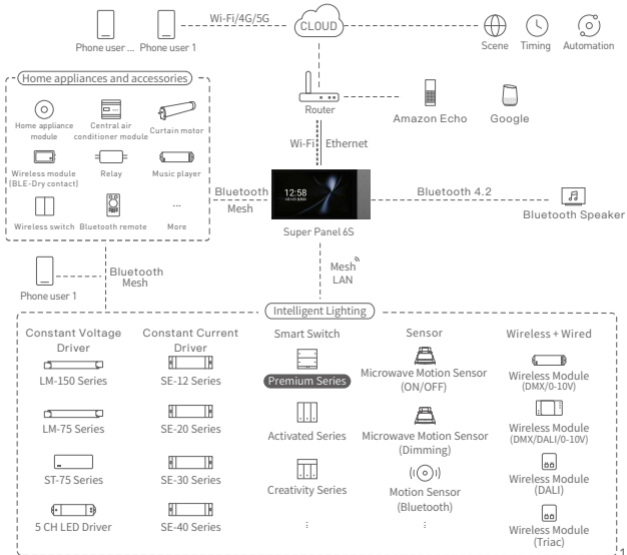

Product Features

- Use CNC aluminum alloy buttons. Available in four colors that can be blended seamlessly into any decorating style.
- 4-gang switch with the latest Bluetooth 5.0 SIG Mesh technology turns traditional lights into smart ones.
- Completely turn lights off and stop LED lights from glowing. It is energy-efficient and secure.
- Work with gateway devices to achieve automation for lighting control.
- Bluetooth 5.0 SIG Mesh with high networking capacity is reliable and stable.
- Support local scenes that can run without the Internet or a gateway. It is faster and more stable
- Designed with the 86 type junction box. No need to modify the existing wiring. Easily install the switch and be ready to use right out of the box.

Technical Specs

Model	S4M
Wireless Protocol Type	Bluetooth 5.0 SIG Mesh
Input Voltage	100-240Vac, 50/60Hz
Loading Range	≤ 200VA/CH [Capacitive load], ≤ 400W/CH [Resistive load]
Working Temperature	-20°C-55°C
Working Humidity	≤ 80%RH
Colors	Grey/ Pink/ Silver/ Gold
Net Weight	160g
Dimensions[L×W×H]	86×86×36.5(mm)
Package Size[L×W×H]	102×102×60(mm)

Product Images

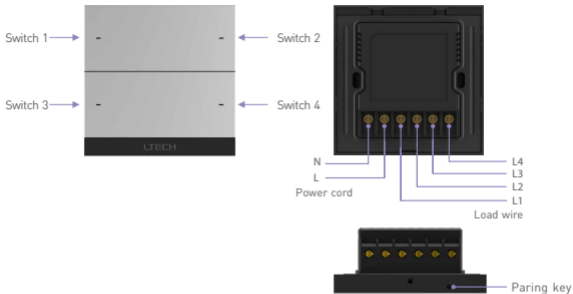

Product Size

Unit: mm

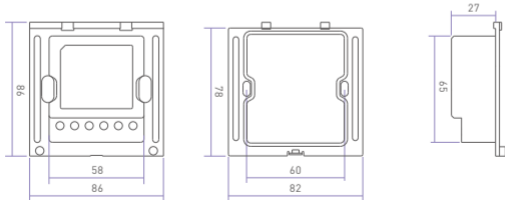

Installation Instructions

1. Turn off the circuit breaker and remove any concrete or corrosion that are inside the wall box. Trim the power cord wire in the wall box to 10cm in length approximately.



2. Pry the switch plate up with a flat head screwdriver.

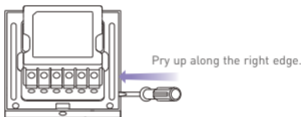

3. Attach the live line to L socket of the switch and the null line to N socket, and the load power cord wire to L1/L2/L3/L4 socket. Make sure the power cord wires are well connected to the switch terminals with no copper wire exposed. (The protection device for the electronic switch cannot be greater than 35A)

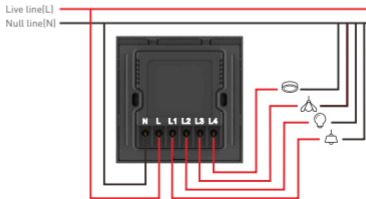

4. Insert the screws into the hole on two sides of the switch and secure the screws to fit the switch to the wall with a screwdriver.

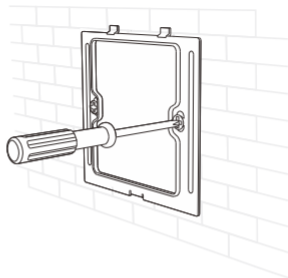

5. Slant the switch plate cover and put it in place, then secure the plate cover to the switch from the bottom with a KM2 screw.

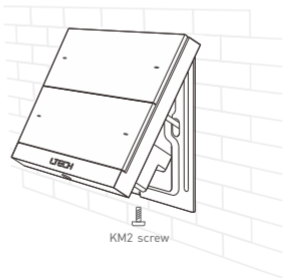

Recommended Applications

1. Connect to traditional lamps and turn them into smart ones.

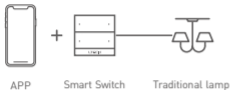

2. Wireless control.

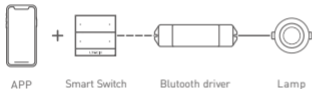

3. Support local scenes that can run without the Internet or a gateway.



4. Visual control + Scene linkage.



5. More applications of intelligent control are waiting for you to set up.

App Operating Instructions

1. Register an account

1.1 Scan the QR code below with you mobile phone and follow the prompts to complete the app installation.



Scan and download the App

1.2 Open the App and log in or register an account.

1.3 Create a home if you are a new user. Click "+" icon in the upper right corner to access "Add Device" list.

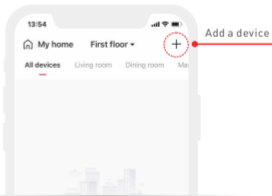
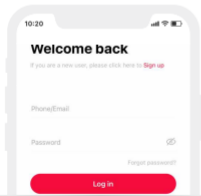

2. How to bind lights/light groups

Bind lights/light groups: Go to the device interface and long press the key you want to bind. Or go to the settings to click the key you want to bind. Then click "Bind object" and pick a light or a light group, and set up turning on/off and adjusting brightness by a short press and a long press. After clicking "Save", you are able to control Bluetooth lights or light groups with a Bluetooth switch panel.

Bind keys of the other switch panel: Go to the device interface and long press the key you want to bind. Click "Bind object" and pick a switch panel, then pick the key of the switch panel you want to bind. The key you pick allows turning on and off, turning on, turning off only. It is recommended to apply to those scenes that require controlling multiple traditional lights.

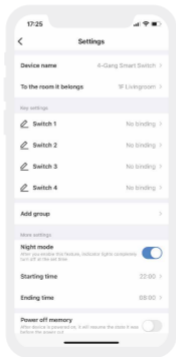

3. How to create a switch panel group

In "Add device" interface, click "Group" and pick the smart switch group you need. Create a smart switch group, then rename the group and set up the room it belongs to. Pick devices you want to add to the group, then the group will be created successfully. After creating the group, the data of sub devices of the group will be synchronized with the other switch panels of the group. So one device can be controlled by multiple panels.

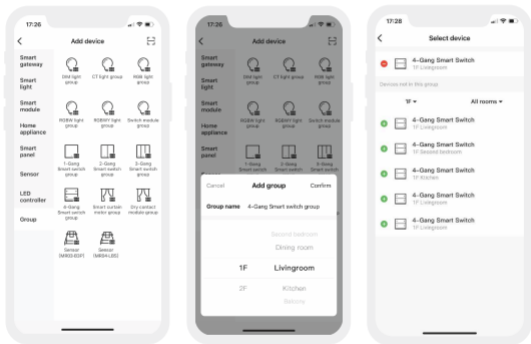

4. Advanced functions

- 4.1 Control the smart switch locally by linking it with a local scene
- 4.2 Work with a smart gateway (such as Super Panel 6S) to achieve a variety of cloud scenes and automatic control. For more details, please follow the on-screen instructions in the APP.

FAQs

1. What should I do if I fail to search the device via APP?

Please check below:

- 1.1 Please make sure the device is powered on normally and is in the activated state.
- 1.2 Please keep your mobile phone and device as close as possible. The recommended distance between them is no more than 15 meters.
- 1.3 Please make sure the device hasn't been added yet. If it has, please reset the device to factory defaults manually.

2. How to reset a switch to factory defaults?

Method 1: Insert a ejection pin into the paring key at the bottom of the panel and long press it for 6s. When all the indicator lights flash slowly, it means that the device has been set to factory defaults.

Method 2: Please long press the last button for 15s and release it until all the indicator lights flash fast. Within 3s, short press the same button 3 times and the indicator light flashes slowly, which means the device has been reset to factory defaults.

Attentions

- Products shall be installed by qualified professionals.
 - LTECH products are non-waterproof (special models excepted). Please avoid the sun and rain. When installed outdoors, please ensure it is mounted in a water proof enclosure.
 - Good heat dissipation will extend the working life of products. Please ensure good ventilation.
 - Please check if the working voltage used complies with the parameter requirements of products.
 - The diameter of wire used must be able to load the light fixtures you connect and ensure the firm wiring.
 - Before you power on products, please make sure all the wiring is correct in case of incorrect connection that causes damage to light fixtures.
 - If a fault occurs, please do not attempt to fix products by yourself. If you have any question, please contact your suppliers.
- * This manual is subject to changes without further notice. Product functions depend on the goods. Please feel free to contact our official distributors if you have any question.

Warranty Agreement

Warranty periods from the date of delivery : 2 years.

Free repair or replacement services for quality problems are provided within warranty periods.

Warranty exclusions below:

- Beyond warranty periods.
 - Any artificial damage caused by high voltage, overload, or improper operations.
 - Products with severe physical damage.
 - Damage caused by natural disasters and force majeure.
 - Warranty labels and barcodes have been damaged.
 - No any contract signed by LTECH.
1. Repair or replacement provided is the only remedy for customers. LTECH is not liable for any incidental or consequential damage unless it is within the law.
 2. LTECH has the right to amend or adjust the terms of this warranty, and release in written form shall prevail.

LTECH

超级智能开关

(四键)



使用说明书

www.ltech.cn

系统图

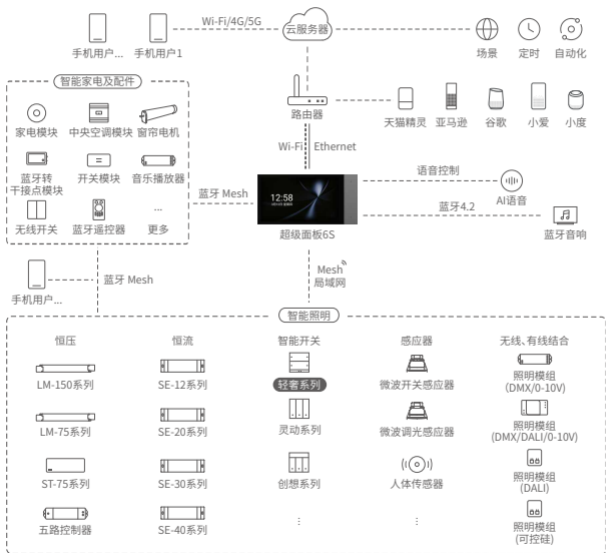

产品介绍

- 采用CNC铝合金按键，多种颜色选择，完美搭配不同的装修风格；
- 4路继电器搭配最新蓝牙5.0 SIG Mesh 技术，传统灯具秒变智能；
- 具有完全通断的功能，节能又安全；
- 可搭配无线蓝牙驱动器，实现灯光开关调光调色控制；
- 可搭配智能网关实现丰富的云场景、自动化控制方式；
- 支持本地场景，去网关，断网可控，更快更稳定
- 标准86底盒结构设计，无需改造，即装即用。

技术参数

型号	S4M
无线类型	Bluetooth 5.0 SIG Mesh
输入电压	100-240Vac, 50/60Hz
负载通断功率	≤ 200VA/路 (容性负载), ≤ 400W/路 (阻性负载)
工作温度	-20°C-55°C
工作湿度	≤ 80%RH
颜色	奢华香槟金 / 梦幻少女粉 / 尊贵金属银 / 轻奢北欧灰
产品净重	160g
产品尺寸	L86×W86×H36.5(mm)
包装尺寸	L102×W102×H60(mm)

产品图示

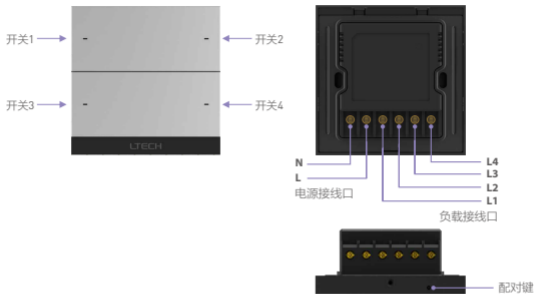

产品尺寸 单位: mm

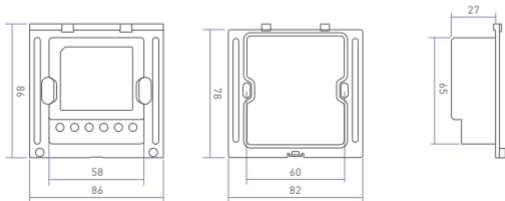

安装步骤

①关闭电源总闸，并确认暗盒内壁无水泥等附着物，将暗盒内的电源线长度修减到10CM左右。

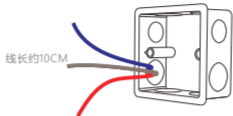

②使用一字螺丝刀撬开底板。

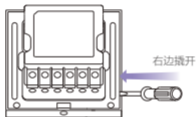

③将火线接入开关面板底壳的L接口，零线接入底壳的N接口，负载电源线接入底壳的L1/L2/L3/L4接口，确认电源线与开关接线柱接触良好，无裸露的铜线。（电子开关的前置保护装置不能高于35A）

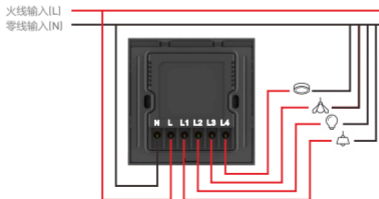

- ④在底板左右两侧螺丝孔位装入螺丝后，使其底板贴合墙面。

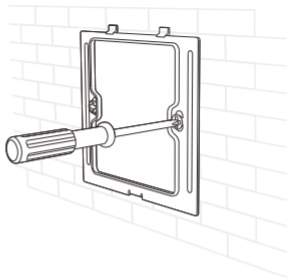

- ⑤倾斜面板并扣合在底板上，用KM2螺丝从面板底部将底板锁紧。

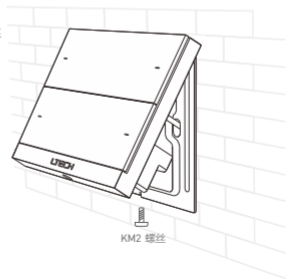

应用组合

1. 连接传统灯具，秒变智能灯具。

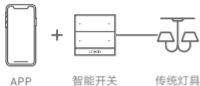

2. 无线控制灯具。

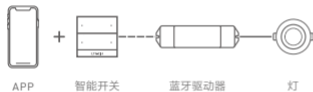

3. 支持本地场景，去网关，断网可控。



4. 可视化控制+场景联动。

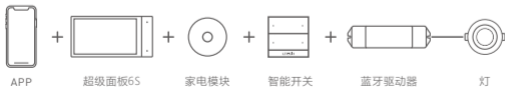

5. ...智能控制，更多应用搭配等您来设置。

APP操作说明

1. 账号注册

1.1 通过手机扫描下方二维码，按提示完成APP安装。



扫码下载APP

1.2 打开APP进行登录/注册操作。

1.3 新用户创建家庭后，点击右上角“+”进入添加设备列表，按照提示添加搜索设备并添加即可。



2. 如何绑定灯/灯组/面板按键

绑定灯/灯组：进入界面后，长按对应按键或进入“设置”界面，点击对应按键，点击“绑定对象”，选择灯/灯组，并设置短按/长按动作后保存，即可使用面板控制蓝牙灯或灯组。

绑定面板按键：进入界面后，长按对应按键，点击“绑定对象”，选择面板及按键，仅支持“开关、开、关”动作。推荐应用于传统灯实现多控的使用场景。



3. 如何创建面板组

在添加设备列表，选择智能开关组，创建群组并设置群组名称及所属房间，点击要加入群组的设备即创建成功。创建成功后，群组内的子设备将同步面板组的数据，实现多地一控。



4. 高级功能

- 4.1 智能开关可通过联动本地场景，实现本地化控制；
- 4.2 可搭配智能网关(比如:超级面板6S)实现丰富的云场景、自动化控制。
具体详情请查看APP操作。

常见问题

1. 设备一直搜索不到怎么办？

请检查以下选项：

- 1.1 确保设备正常通电，并且处于激活状态；
- 1.2 确保手机与设备两者尽量靠近，建议不超过15米；
- 1.3 确保设备未被添加过，如被添加过，请手动恢复出厂。

2. 如何恢复出厂？

方法一：使用取卡针长按面板底部配对键6秒，直到全部指示灯慢闪，即表示设备已恢复到出厂状态。

方法二：长按最后一个按键15秒，直到所有按键指示灯快闪后松开，在3秒内短按同一按键3次，指示灯慢闪，设备恢复到出厂状态后，指示灯快闪3秒。

注意事项

- 请由具有专业资格的人员进行调试安装；
 - 雷特产品(专有型号除外)不能防水，需避免日晒雨淋，如安装在户外，请用防水箱；
 - 良好的散热条件会延长产品的使用寿命，请把产品安装在通风良好的环境；
 - 请检查使用的工作电压是否符合产品的参数要求；
 - 使用的电线直径大小必须能够负载连接的LED灯具，并确保接线牢固；
 - 通电调试前，应确保所有接线正确，以避免因接线错误而导致灯具损坏；
 - 如果发生故障，请勿私自维修；如有疑问，请联系供应商。
- * 本说明书的内容如有变更，恕不另行通知。若内容与您使用的功能有所不同，则以实物为准。如有疑问，欢迎向我司授权的经销商咨询。

保修条例

- 自出厂之日起保修服务期为2年。
- 在保修服务期内出现产品质量问题雷特将给予免费修理或更换服务。

非保修条例：

属下列情况不在免费保修或更换服务范围之内：

- 已经超出保修期限的；
 - 过高电压、超负载、操作不当等人为造成的损坏；
 - 产品外形严重损坏或变形；
 - 自然灾害以及人力不可抗拒原因造成的损坏；
 - 产品保修标签和产品唯一条形码损坏。
 - 无雷特签订的合同或发票凭证。
1. 修理或更换是雷特对客户的一补救措施。雷特不承担任何附带引起的损害赔偿，除非在适用法律范围之内。
 2. 雷特享有修正或调整本保修条款的权利，并以书面形式发布为准。